

# EVALARM eLearning (LMS)



After the introduction of a new software system, the challenge is to train users in how to use it. For this we have developed the EVALARM learning platform, which gives users the opportunity to familiarize themselves with the functional scope of our platform.

The various learning courses deal with the use of the mobile app and the web cockpit as well as the administration of the platform and the additional modules. This means that every user, from simple users to administrators, can acquire the necessary basic knowledge and check it in knowledge tests at the end of each course.

The eLearning platform helps to provide users with general knowledge in dealing with EVALARM, our wiki is available for detailed knowledge.

You also have the option of obtaining two EVALARM LMS certificates. Please contact [support@evalarm.de](mailto:support@evalarm.de).

The following steps show how you can easily register on the learning platform in a few steps:

## Step 1)

Visit the website of our eLearning platform [lms.evalarm.de](https://lms.evalarm.de) and click on the "No account? Sign Up" button on the start page.

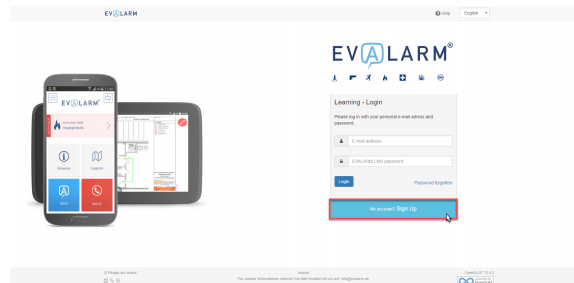

## Step 2)

Choose your language and enter your preferred email address. After clicking submit, you will receive an email with the instructions to complete the registration.

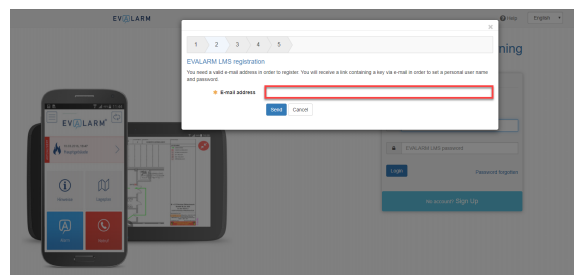
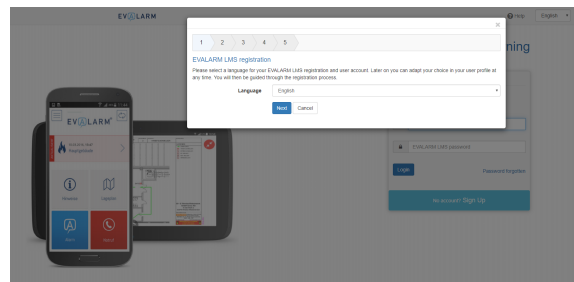

## Step 3)

Via the link in the email you will reach the following page of the eLearning platform (see picture on the right side). Enter your name, user name and password and complete the process with "Send".

EV@LARM

1 2 3 4 5

### EV@LARM LMS registration

In order to finish your registration, please fill in the form.

A user name

- must contain at least 4 characters
- may only contain digits and/or lower case letters (no special digits or umlauts except for -)
- cannot be changed later on

A password

- must contain at least 4 characters
- must contain letters and at least one digit
- must not contain umlauts or other special letters like ü, ß, &
- must not contain blanks or escape sequences
- may contain the following special characters: !@#\$%^&\*~.-/\_:;'+=<>?@{}~\_[]-`

### EV@LARM LMS registration

First name

Last name

Language

User name

New password

Confirm password

[Go to top](#)

EV@LARM

1 2 3 4 5

### EV@LARM LMS registration

Please read the terms of use before proceeding.

#### Terms of use

An EVALARM LMS user should be aware that EVALARM LMS can only be used for study or teaching purposes. We're not responsible for any legal issues concerning public behavior and/or the rights of third parties (right to a name, copyright, data protection, etc.). Specifically, the EVALARM LMS user undertakes not to propagate any material of pornography, racism, illegal, discriminatory or violent nature, or to store such material on the EVALARM LMS Server. Furthermore he/she undertakes not to incite or provide any kind of material for incitement.

The service operator of this platform reserves the right to block access to the EVALARM LMS server for any user contravening the above conditions and to erase the user's data. The service operator furthermore reserves the right to involve legal proceedings in such a case.

☒ I have read your terms of use, do understand and agree.

[Print "Terms of use"](#)

[Go to top](#)

EV@LARM

1 2 3 4 5

### EV@LARM LMS registration

#### Summary of your data

You can now log in with your user name **user1** and password

User name	user1
First name	Example
Last name	User

[Go to top](#)

In the next step you have to accept the terms of use.

Finally, you will see a brief summary of your information and have the opportunity to log into the learning platform for the first time.

Follow the four short steps to unlock the learning courses.

EV@LARM Start Courses Groups

Welcome to the EVALARM eLearning!

To register for the EVALARM eLearning courses, please follow the following 4 easy steps:

- Select „Published Groups“
- Click „Groups“
- „Book“ your Group (De/En)
- Click „Book“

[Go to top](#)

You will find all of your learning courses in the "Courses" section under the "My courses".

To start a course, go to the corresponding button on the right side of the respective course.

The screenshot displays the EVALARM web application interface. At the top, there is a navigation bar with the EVALARM logo and tabs for 'Start', 'Courses', and 'Groups'. The 'Courses' tab is currently selected and highlighted with a red box. Below the navigation bar, there is a sub-navigation bar with tabs for 'Favourites', 'My courses', 'Finished', 'Catalog', and 'Search'. The 'My courses' tab is also selected and highlighted with a red box. The main content area shows a list of 7 entries under the heading '7 Entries'. Each entry represents a course and includes a thumbnail image, a title, a description, and a 'start' button. The courses listed are:

- A. Content and structure of the e-Learning platform**  
with Administrator  
In this course we want to give you some informations about the e-Learning platform.  
Info page start
- B. What is EVALARM?**  
with Administrator  
In this course we want to present the functions and the structure of EVALARM to you.  
Info page start
- C. EVALARM mobile APP**  
with Administrator  
In this course we are going to show you, how to download the app and sign in. Furthermore we introduce you to the structure of the EVALARM App and which profile settings you can edit. We show you how to create, receive and edit alarms.  
Info page start
- D. Functional scope Cockpit**  
with Administrator  
In this course we show you the functionalities of the cockpit in the web-based backend. You'll learn how to create, monitor and evaluate alarms in the cockpit.  
Info page start
- E. Administration of the EVALARM platform**  
with Administrator  
In this course we show you how to configure the EVALARM backend as an administrator.  
Info page start